

Legend

|             |                    |          |                     |
|-------------|--------------------|----------|---------------------|
|             |                    |          |                     |
| North Point | Maddington Station | Road     | Shared Path         |
|             |                    |          |                     |
| Scale       | Bus Stand Number   | Pathways | Non-Accessible Area |
|             |                    |          |                     |
| 0 20m       | Bus Stop           | Platform |                     |
|             |                    |          |                     |
|             | Transperth Parking |          |                     |

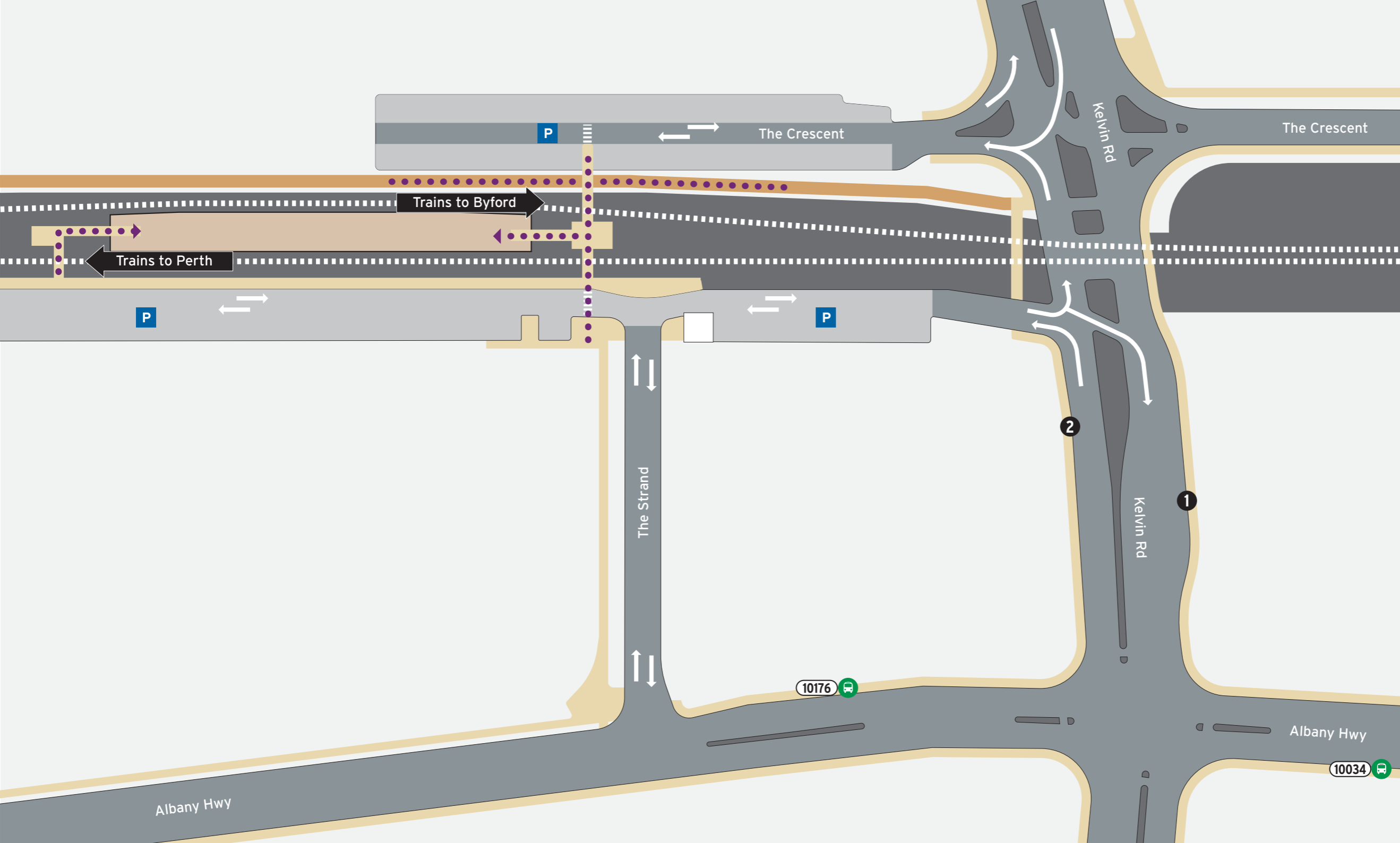

**Bus Stands**

| Stand | Route                           |
|-------|---------------------------------|
| 1     | 209, 210                        |
|       | 228 to Thornlie Stn             |
|       | 229, 279 to Maddington Central  |
|       | Transperth School Specials      |
| 2     | 228 to Gosnells Stn             |
|       | 229 Carousel Shop Ctr           |
|       | 279 Kalamunda Bus Stn           |
|       | Transperth School Specials      |
|       | 10034 220 to Perth Busport      |
| 907   | Train Replacement to Perth      |
| 10176 | 220 to Armadale Stn             |
| 907   | Train Replacement to Byford Stn |

**Legend**

North Point

Scale  
0 15m

|                           |                             |                     |             |
|---------------------------|-----------------------------|---------------------|-------------|
| <b>1</b> Bus Stand Number | <b>P</b> Transperth Parking | Road                | Shared Path |
| Bus Stop                  |                             | Pathways            |             |
| Accessible Path           |                             | Non-Accessible Area |             |
|                           |                             | Platform            |             |

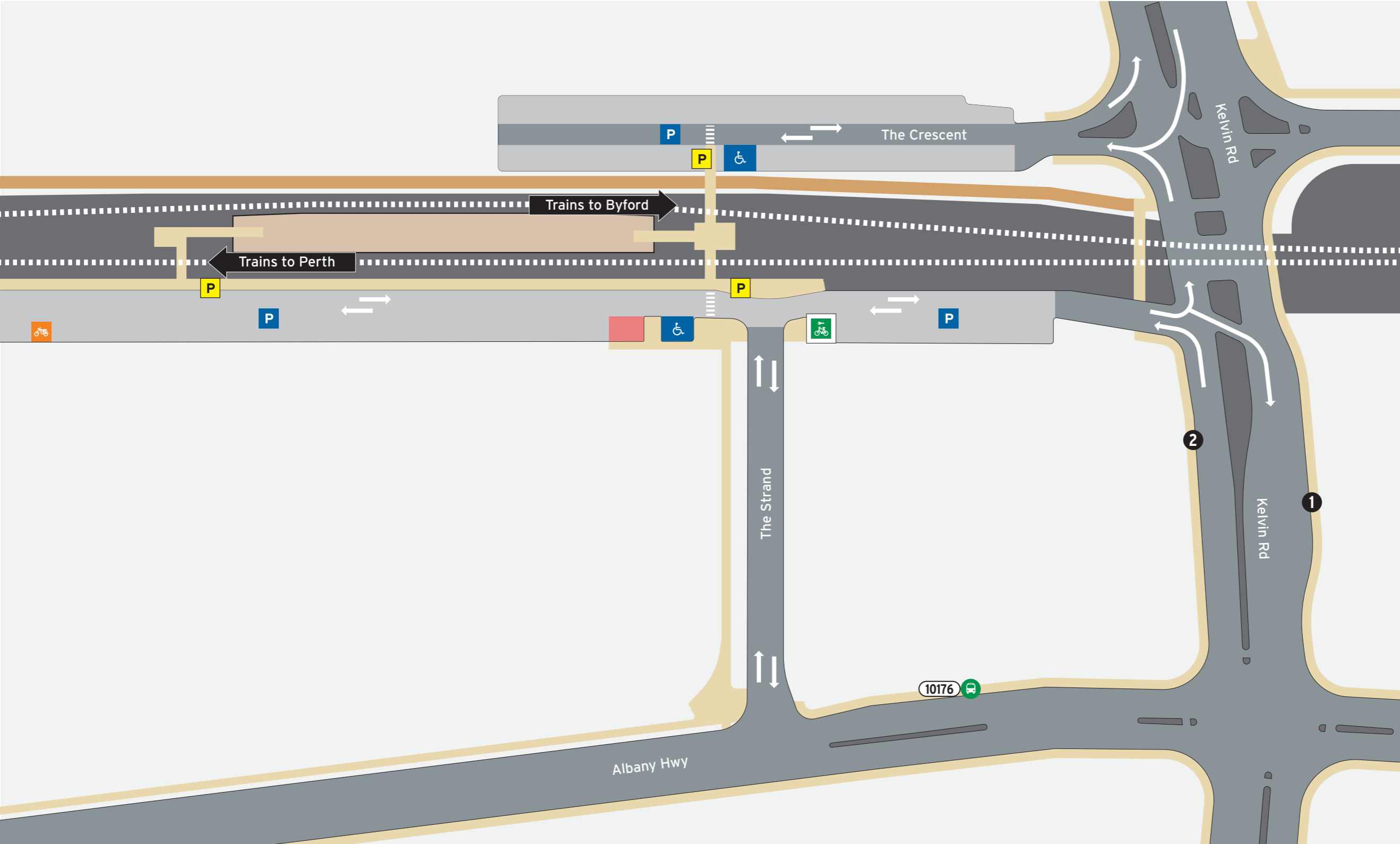

**P** | **Parking Information**

**When to pay**

**Operating Times**

Monday-Friday Fee applies  
 Saturday No charge  
 Sunday or Public Holiday No charge\*  
 \*Unless vehicle is parked overnight

\$2.00 per 24hr period or part there of applies.

This parking charge applies to all vehicles.

For more information on parking your vehicle visit [transperth.wa.gov.au](http://transperth.wa.gov.au)

**Legend**

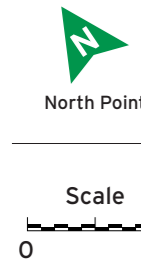

- |                        |                     |                     |             |
|------------------------|---------------------|---------------------|-------------|
| Transperth Parking     | SmartParker Machine | Road                | Shared Path |
| ACROD Parking          | Bike Shelter        | Pathways            |             |
| PTA Authorised Parking | Motorbikes          | Non-Accessible Area |             |
|                        |                     | Platform            |             |